



Operating Instructions and Parts Manual

Folding Hydraulic Crane

Model: JFHC-200X



WMH TOOL GROUP
2420 Vantage Drive
Elgin, Illinois 60123
Ph.: 800-274-6848
www.wmhtoolgroup.com

Part No. M-106206K
Revision G 10/06
Copyright © WMH Tool Group

WARRANTY AND SERVICE

WMH Tool Group, Inc., warrants every product it sells. If one of our tools needs service or repair, one of our Authorized Service Centers located throughout the United States can give you quick service. In most cases, any of these WMH Tool Group Authorized Service Centers can authorize warranty repair, assist you in obtaining parts, or perform routine maintenance and major repair on your JET® tools. For the name of an Authorized Service Center in your area call 1-800-274-6848.

MORE INFORMATION

WMH Tool Group is consistently adding new products to the line. For complete, up-to-date product information, check with your local WMH Tool Group distributor, or visit jettools.com.

WARRANTY

JET products carry a limited warranty which varies in duration based upon the product (MW stands for Metalworking, WW stands for Woodworking).

90 DAY WARRANTY	1 YEAR WARRANTY	2 YEAR WARRANTY	5 YEAR WARRANTY	LIFE LIFETIME WARRANTY
Lathe Accessories Machine Accessories Mobile Bases Safety Equipment Specialty Items	Contractor Air Tools Hydraulic & Shop Tools Industrial Air Tools Light Industrial Air Tools Overhead Lifting Warehouse & Dock Equipment Winches	Metalworking Mechanical Components: Cold Saws MW Finishing Equipment Metalforming MW Lathes Mill/Drills MW Vises Milling Machines Surface Grinders MW Bandsaws Tapping MW Drill Presses	Air Filtration Sanders Buffers Shapers Dust Collectors Tablesaws Dust Filters WW Bandsaws Dust Fittings WW Drill Presses Jointers WW Lathes Planers	Fastening Tools Lubrication Mechanics Hand Tools Striking Tools Vise Accessories Vises (non-MW) Clamps Workholding
<i>Metalworking Electrical Components on above products carry 1 Year Warranty</i>			<i>Warranty reverts to 1 Year if above products are used for commercial, industrial or educational purposes</i>	

WHAT IS COVERED?

This warranty covers any defects in workmanship or materials subject to the exceptions stated below. Cutting tools, abrasives and other consumables are excluded from warranty coverage.

WHO IS COVERED?

This warranty covers only the initial purchaser of the product.

WHAT IS THE PERIOD OF COVERAGE?

The general JET warranty lasts for the time period specified in the product literature of each product.

WHAT IS NOT COVERED?

Five Year and Lifetime Warranties do not cover products used for commercial, industrial or educational purposes. Products with Five Year or Lifetime Warranties that are used for commercial, industrial or education purposes revert to a One Year Warranty. This warranty does not cover defects due directly or indirectly to misuse, abuse, negligence or accidents, normal wear-and-tear, improper repair or alterations, or lack of maintenance.

HOW TO GET SERVICE

The product or part must be returned for examination, postage prepaid, to a location designated by us. For the name of the location nearest you, please call 1-800-274-6848.

You must provide proof of initial purchase date and an explanation of the complaint must accompany the merchandise. If our inspection discloses a defect, we will repair or replace the product, or refund the purchase price, at our option. We will return the repaired product or replacement at our expense unless it is determined by us that there is no defect, or that the defect resulted from causes not within the scope of our warranty in which case we will, at your direction, dispose of or return the product. In the event you choose to have the product returned, you will be responsible for the shipping and handling costs of the return.

HOW STATE LAW APPLIES

This warranty gives you specific legal rights; you may also have other rights which vary from state to state.

LIMITATIONS ON THIS WARRANTY

WMH TOOL GROUP LIMITS ALL IMPLIED WARRANTIES TO THE PERIOD OF THE LIMITED WARRANTY FOR EACH PRODUCT. EXCEPT AS STATED HEREIN, ANY IMPLIED WARRANTIES OR MERCHANTABILITY AND FITNESS ARE EXCLUDED. SOME STATES DO NOT ALLOW LIMITATIONS ON HOW LONG THE IMPLIED WARRANTY LASTS, SO THE ABOVE LIMITATION MAY NOT APPLY TO YOU.

WMH TOOL GROUP SHALL IN NO EVENT BE LIABLE FOR DEATH, INJURIES TO PERSONS OR PROPERTY, OR FOR INCIDENTAL, CONTINGENT, SPECIAL, OR CONSEQUENTIAL DAMAGES ARISING FROM THE USE OF OUR PRODUCTS. SOME STATES DO NOT ALLOW THE EXCLUSION OR LIMITATION OF INCIDENTAL OR CONSEQUENTIAL DAMAGES, SO THE ABOVE LIMITATION OR EXCLUSION MAY NOT APPLY TO YOU.

WMH Tool Group sells through distributors only. The specifications in WMH catalogs are given as general information and are not binding. Members of WMH Tool Group reserve the right to effect at any time, without prior notice, those alterations to parts, fittings, and accessory equipment which they may deem necessary for any reason whatsoever. JET® branded products are not sold in Canada by WMH Tool Group.

Warnings

1. Study and understand all operating instructions before operating crane.
2. Do not exceed the rated capacity of the crane (position 1, 1/2 ton, position 2, 1 ton, position 3, 1-1/2 ton, position 4, 2 ton).
3. Assure that the load is not allowed to drop suddenly or swing during transporting.
4. Make sure that boom is fully lowered before adding oil to unit reservoir.
5. This shop crane is designed for use only on hard, level surfaces capable of sustaining the load. Use on other than hard level surfaces can result in shop crane instability and possible loss of load.
6. Slowly lower boom and load to the lowest possible position before transporting load.
7. Assemble crane according to the owner's manual. Make sure all bolts and nuts are tight before placing crane into operation.
8. Do not use crane for any other purpose than for which it was designed and intended.
9. Boom extension hardware must be secure before attempting to lift any load.
10. Never place any part of the body under the load or crane while in use.
11. Never use the crane as the only means of support. Always move the load to a stable platform or work surface before attempting any work.
12. Keep others away from the area while the crane is in operation.
13. Boom must be in fully lowered position before raising legs. Legs must never be raised when crane is carrying load. Legs must be locked in place.
14. Before attempting to raise load, make sure it is securely fastened and safety latches are secure.
15. Do not operate crane with twisted or kinked chain.
16. Do not remove labels from crane.
17. Never use crane for lifting people or loads over people.
18. Do not remove ram and use separately for any purpose.
19. Never operate the crane under the influence of medication, drugs or alcohol.
20. Failure to comply with all of these warnings may result in loss of load, damage to the shop crane, and/or failure resulting in personal injury or property damage.

Familiarize yourself with the following safety notices used in this manual:

CAUTION This means that if precautions are not heeded, it may result in minor injury and/or possible machine damage.

WARNING This means that if precautions are not heeded, it may result in serious injury or possibly even death.

Specifications

Model Number..... JFHC-200X
 Stock Number 106203K

Capacity (tons)	Boom Height		Boom Length	Reach	Overall Height	Base Length		Base Width (Outside)		Length Inside Legs		Wheel Diameter	Chain Size	Net Weight
	Max	Min				Max	Min	Max	Min	Max	Min			
1/2 T Position 1	105-1/4"	3-5/8"	63-1/8"	47-7/8"	58"	68-1/2"	21-1/2"	38"	32"	51"	51"	3-1/2"	3/8 x 12	222 lbs
1 T Position 2	100-1/4"	9-3/4"	56"	40-3/4"	58"	68-1/2"	21-1/2"	38"	32"	51"	51"	3-1/2"	3/8 x 12	222 lbs
1-1/2 T Position 3	94-1/2"	15-3/4"	49"	33-3/4"	58"	68-1/2"	21-1/2"	38"	32"	51"	51"	3-1/2"	3/8 x 12	222 lbs
2 T Position 4	88-3/8"	22"	41-7/8"	26-1/2"	58"	68-1/2"	21-1/2"	38"	32"	51"	51"	3-1/2"	3/8 x 12	222 lbs

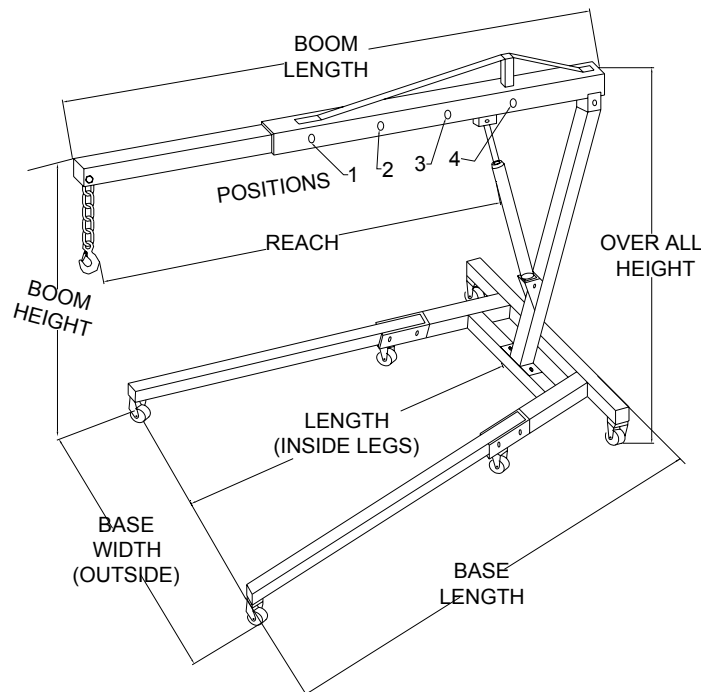

The specifications in this manual are given as general information and are not binding. WMH Tool Group reserves the right to effect, at any time and without prior notice, changes or alterations to parts, fittings, and accessory equipment deemed necessary for any reason whatsoever.

WARNING Read and understand the entire contents of this manual before attempting assembly or operation! Failure to comply may cause serious injury!

TEST CERTIFICATE

COMMODITY	Hydraulic Shop Crane
MODEL	JFHC-200X
SERIAL NO.	
CAPACITY	2 Ton
TEST LOAD	2 Ton
DATE OF INSPECTION	
JUDGEMENT	PASSED
INSPECTOR	

Assembly

Note: Refer to parts breakdown for index numbers found in parenthesis (#):

1. Attach Front Legs (2) to the Frame Base (1) using all four Hitch Pins (24), and Hitch Pin Clips (24A). On each leg, insert one pin through Frame Base and Front Leg at rear hole. The hitch pin serves as a pivot pin and remains in the hole permanently. Insert a second hitch pin in the forward hole through the Frame Base and Front Leg. This locks the legs in the down and/or up position.
2. Insert Hitch Pin Clips through Hitch Pins to secure in place.
3. Attach the Main Support Post (9) to the Frame Base using two Hex Cap Screws (18), two Flat Washers (26) and two nuts (23).
4. Attach Support Straps (5) to the top of the Main Support Post using Steer Handles (14) and Flat Washers (15).
5. Connect the Support Straps to the Frame Base using two Hex Cap Bolts (18), two Flat Washers (26) and two Hex Nuts (23).
6. Connect the bottom of the Hydraulic Ram Assembly (6) to the Main Support Post using a Hex Cap Screw (16), Flat Washer (15), and Hex Nut (22).
7. Connect the Boom (3) to the Main Support Post using a Hex Cap Screw (19), Flat Washer (30) and Hex Nut (21).
8. While another person supports the Boom up attach the top of Hydraulic Ram Assembly to the Boom with a Hex Cap Screw (17), Flat Washer (15), and Hex Nut (22).
9. Slide the Boom Extension (4) into the Boom with the slot for Hook and Chain Assembly (8) facing down.
10. Install Chain and Hook Assembly with a Hex Cap Screw (20), Flat Washer (26) and Hex Nut (23).
11. Insert the Plastic End Caps (27 & 28) into the ends of legs, boom and boom extension.
12. Make sure all hardware is tight.

Operation

1. Load to be lifted must be securely attached with a sling or chain of adequate size and strength. Before lifting the load, be sure the load cannot twist or fall.
2. Move crane into position. Legs must be extended and lock pinned into place. Never use crane with legs in the upright position.
3. Close hydraulic valve at the base of ram by inserting handle groove onto valve and turning clockwise until tight.
4. Place sling or chain in center of hook and make sure safety latch is secured.
5. Slowly raise the load to desired height by inserting handle into ram and pumping handle.
6. Move load to desired location by rolling crane assembly. Use caution so that load does not swing or rotate.
7. Slowly lower load to desired location by inserting ram handle onto valve at base of the ram and slowly turning counter-clockwise. Do not lower too quickly. Make sure the load is secure once lowered fully.

Parts

Ordering Replacement Parts

To order parts or reach our service department, call 1-800-274-6848 between 7:30am and 5:30pm (CST), Monday through Friday. Having the Model Number and Serial Number of your machine available when you call will allow us to serve you quickly and accurately.

Hydraulic Crane Parts List

Index No.	Part No.	Description	Size	Qty
1	JFHC200C-1	Frame Base		1
2	JFHC200C-2	Front Leg		2
3	JFHC200C-3	Boom		1
4	JFHC200C-4	Boom Extension		1
5	JFHC200C-5	Support Strap		2
6	JFHC200X-6	Hydraulic Ram Assembly		1
7	JFHC200C-7	Pump Handle		1
8	JFHC200C-8	Hook & Chain Assembly		1
9	JFHC200C-9	Main Support Post		1
14	JFHC200X-14	Steer Handle		2
15	TS-155010	Flat Washer	M16	4
16	TS-149B15	Hex Cap Screw	M16x90	1
17	TS-149B12	Hex Cap Screw	M16x75	1
18	TS-149A15	Hex Cap Screw	M14x100	4
19	TS-149C18	Hex Cap Screw	M20x120	1
20	TS-149A12	Hex Cap Screw	M14x75	1
21	TS-1540121	Nut	M20	1
22	TS-1540101	Nut	M16	2
23	TS-154009	Nut	M14	5
24	JFHC200C-24	Hitch Pin		4
24a	JFHC200C-24a	Hitch Pin Clip		4
25	JFHC200X-25	Boom Hitch Pin w/Hitch Pin Clip		1
26	TS-155009	Flat Washer	M14	5
27	JHC200C-25	Plastic End Cap	2-3/4"	5
28	JHC200C-25A	Plastic End Cap (boom extension)	2-1/4"	1
30	TS-155011	Flat Washer	M20	1
31	JFHC200X-ID	I.D. Label		1
32	JFHC200X-WL	Warning Label		1
60	JFHC200C-60	Front & Back Caster	3-1/2"	4
61	TS-1490021	Cap Screw	M8x16	16
62	JFHC200C-62	Mid Caster	2-3/4"	2
63	TS-1490011	Cap Screw	M8x12	8
64	TS-1551061	Lock Washer	M8	24
65	TS-1540061	Hex Nut	M8	16

Hydraulic Crane Assembly

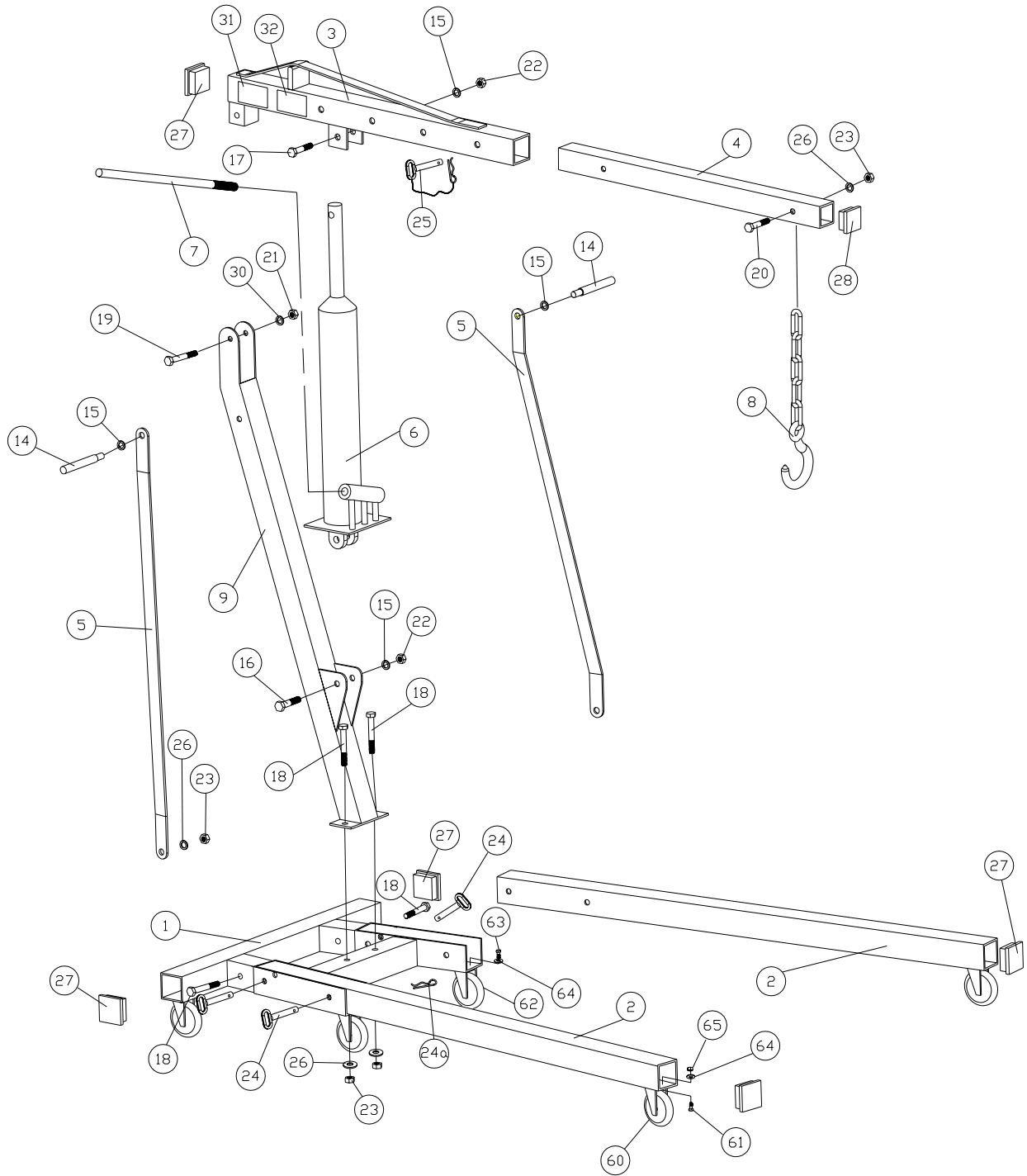

Hydraulic Ram Parts List

Index No.	Part No.	Description	Size	Qty
	JFHC200X-6	Hydraulic Ram Assembly		1
30	JFHC200X-30	Valve Body		1
31	JFHC200X-31	Copper Washer *	M46	1
32	JFHC200X-32	Cylinder		1
33	JFHC200X-33	O-ring *	M40x5.5	1
34	JFHC200X-34	O-ring Retainer *	M31.3x3.55	1
35	JFHC200X-35	Ram		1
36	JFHC200X-36	Top Nut	M48	1
37	JFHC200X-37	O-ring *	M33.5x3.55	1
38	JFHC200X-38	Gasket *	M70x1	1
39	JFHC200X-39	Oil Chamber		1
40	JFHC200X-40	Oil Plug *	M15x9.5	1
41	JFHC200X-41	Seal Ring *	M81x4	1
42	JFHC200X-42	Tube		1
43	SB-6MM	Steel Ball	M6	1
44	JFHC200X-44	Seal Ring *	M88x6	1
45	JFHC200X-45	Release Valve		1
46	SB-6MM	Steel Ball	M6	2
47	JFHC200X-47	Copper Washer *	M18	2
48	JFHC200X-48	Pump Cylinder		2
49	JFHC200X-49	O-ring *	M66x3	2
50	JFHC200X-50	Back-up Ring *	M12x7	2
51	JFHC200X-51	Plunger		2
52	JFHC200X-52	Link Pin		1
53	JFHC200X-53	Handle Socket		1
54	JFHC200X-54	Connecting Pin		3
55	JFHC200X-55	Cotter Pin		3
56	JFHC200X-56	Pin	M2x30	1
57	JFHC200X-57	Bolt	M14x45	1
	JFHC200X-RK	Ram Repair Kit (* indicates included with repair kit)		

